



Picnic Point High School

Return to School Virtual Meeting

Level 3 plus

Wednesday 20 October 2021

6.30pm

Acknowledgement of Country



I would like to acknowledge the Darug people who are the traditional custodians of the land upon which we stand. I would like to pay respect to the Elders past, present and emerging.

I also acknowledge the Ongoing Custodians of the various lands on which you are all calling in from today and the Aboriginal and Torres Strait Islander people participating in this assembly and throughout our school community.

Acknowledgement of Country



I would also like to acknowledge that I am hosting this meeting from the lands of the Wallumettagal people.

I would like to pay my respect to the Elders past, present and emerging.

What we'll cover in this session



- Key dates
- Vaccinations
- COVID-safe practices at PPHS
- HSC
- Where to find out more
- Questions and answers

Return to onsite learning

Picnic Point High School students in Years 7-11 will return to face-to-face learning on Monday 25 October - Week A Timetable.



Vaccinations

COVID-19 vaccination is the best protection against severe illness and also reduces the risk of spreading it to others.

All staff on site supporting the return to school are fully vaccinated from 18 October as mandated by DoE.

A system is in place to verify confirmation of vaccination status.

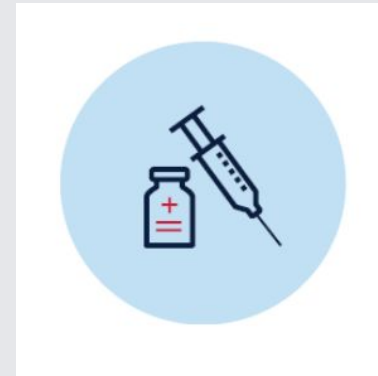

What you need to know about our return to school in Term 4

We're excited about our return to face-to-face learning and welcoming students and staff back onsite where we know the best learning happens.

Our return to school plan is approved by NSW Health and includes numerous effective practices to support the health and wellbeing of our students and staff.

These practices include vaccinations, mask wearing, reduced mingling of student groups and staff, ventilation in classrooms and continued good hygiene and cleaning.



Keeping student groups together



As we return to school, students will be kept in their cohorts to provide a safe learning environment for students and minimise opportunities for transmission of COVID-19 and enabling the most effective contact tracing and containment measures in the event of a COVID-19 case.

The Cohort Model is designed to:

- minimise unnecessary physical interaction between students on school grounds
- ensure that students learn and play only with those in their cohort, wherever possible
- minimise opportunities for transmission and enhance contact tracing
- minimise the potential for widespread infection across the school and wider school community
- enable learning to be delivered safely and effectively via face-to-face and home-based learning.

Keeping student groups together

Secondary School Settings



- Secondary Schools will adopt a year-based cohorting, which will determine their arrival, break and leave times.
- Within each cohort, students should maintain strict personal hygiene and physical distancing.
- Masks are required to be worn by all students indoors.
- Students who are unable to return to school will continue to be supported to learn from home in line with current guidelines.
- Students in support classes will return in line with their year group on Monday 25 October.

Entry and Exit Cohort Entries

Picnic Point High School has 3 entry and exit points into the school. Year groups should enter the school as per following:

Year 7 - Kennedy Street Pedestrian Crossing Gate

Year 8 - Kennedy Street Pedestrian Crossing Gate

Year 9 - Shari Ave Gate

Year 10 - Shari Ave Gate

Year 11 - Kennedy Street Automated Pedestrian Gate

Year 12 - Kennedy Street Automated Pedestrian Gate

Please note: Stretham Ave Gate is not an access gate due to upcoming construction work. This gate is an emergency exit only.

School Gate Entry and Exits



ENTRY TO SCHOOL

School will commence at 8.45am.

Entry to school is through the assigned cohort gate.

On arrival, students are to go to their assigned Playground location.

Exit from School

Students are to leave from the assigned exit gate.

Finish times are staggered as follows:

- 2.55pm: Yr 8, 10, Sp.Ed
- 3.05pm: Yr 7, 9, 11

Cohort Playground Locations



Year 7 - Front Oval

Year 8 - Basketball Courts & Gazebo area

Year 9 - Aboriginal Garden & Futsal Court

Year 10 - Lower Quad

Year 11 - Top Quad, Cafe

Wet Weather:

Year	Before School	Recess/Lunch
7	A Block 1 st Floor	Allocated Classrooms
8	B Block 1 st Floor	
9	Gym	
10	Lower Quad COLA	
11	Top Quad COLA	

Cohort Toilet Entry Locations

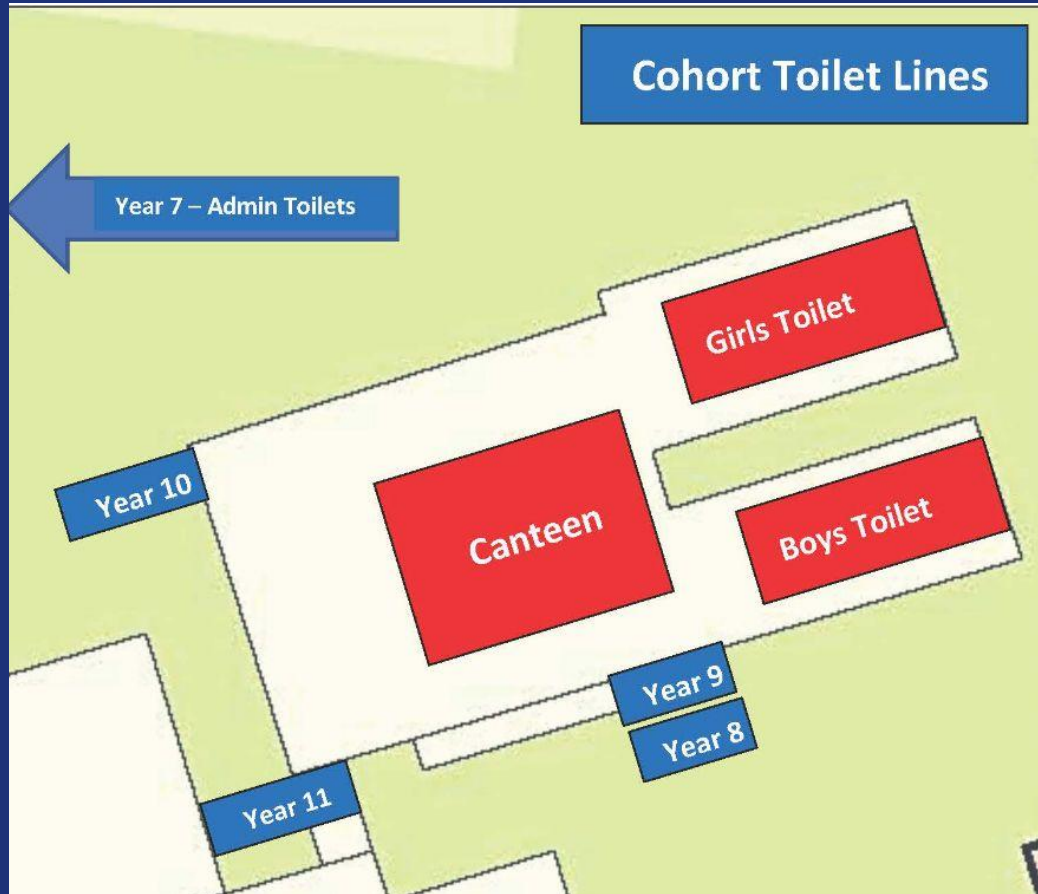

Year 7 - Admin Demountable toilets

Year 8 - Toilet Entry Ramp

Year 9 - Toilet Top Walkway

Year 10 - Canteen Entry Gate

Year 11 - Canteen Exit Gate



CANTEEN

Canteen Term 4 2021

Ordering	PRE-ORDER FOOD FOR RECESS AND LUNCH ONLY 1. Online via Flexischools app 2. Order placed into Canteen Boxes.
-----------------	--

Locked Canteen Box located in Blocks A, B, C, E	Menu Slips, Lunch Bags and locked Canteen boxes are located in Blocks A, B, C and E. Students must use their own pen, complete the Menu slip and place the Menu slip and money into the lunch bag.	
LOCKED CANTEEN BOX CUT OFF TIMES: <ul style="list-style-type: none"> • Recess Order Cut-off time is 9.15am • Lunch Order Cut-off time is 11.30am 		

Flexi Schools	The P&C have implemented an online ordering system, Flexischools .	
<ol style="list-style-type: none"> 1. Download the App 2. Enter your details 3. Search for Picnic Point High School 4. Top up money or Set spending limits via the app. 		
FLEXISCHOOLS ONLINE ORDER CUT OFF TIMES: <ul style="list-style-type: none"> • Recess Order Cut-off time is 10.00am • Lunch Order Cut-off time is 12.00pm 		

Food Collection	Recess and Lunch Orders will be delivered to the relevant cohort blocks just before Recess and Lunch.
------------------------	---

Please leave a '✓' in each box for the item being ordered or write the number of how many of an item you are ordering (2 or more).
 Leave money secured inside your folded lunch bag and any change will be issued with the lunch order.

CANTEEN ORDER FORM -TERM 4 PHASE 1

Name: _____
 Roll Call: _____
 Recess/Lunch: _____

ITEM	PRICE	✓
------	-------	---

HOT FOOD		
Chicken Wedge Pack	\$2.00	
Spinach and Ricotta Roll	\$3.00	
Sausage Roll	\$4.50	
Cheese Pide	\$4.50	
Spinach Pide	\$5.00	
Meat + Cheese Pizza	\$5.00	
Thai Chicken Curry	\$5.00	

SNACKS		
Sea Salt Chips	\$1.50	
Grainwaves	\$1.50	

DRINKS		
Water	\$1.50	
Coke Zero Can	\$2.00	
Glee Can (Tropical)	\$2.00	
Glee Can (Raspberry)	\$2.00	
Glee Can (Grape)	\$2.00	



FLEXISCHOOLS ONLINE ORDERING



Set up your account

1 Download the Flexischools App

Note: for iPhone and iPad please select 'Allow' notifications.

2 Login/Register

- **Already a Flexischools user** – Enter your details and login. To save your login details select 'remember me'.
- **New Flexischools user** – Click '**Register**', enter your email address and follow the instructions in the email to set up your account. Once your account is set up, add new student; search for their school, enter student details and select their class.

3 Top Up Your Account

To make ordering fast and simple, you can set up automatic top ups in your '**User Profile**'.

Order

1 Place your Order

On the app home screen, scroll down to view your school services such as canteen and uniforms. Then **swipe left and right** to view all available services.

2 Make your Selection

Find the service and press '**Order**', then select the items you wish to order.

3 Make Payment

Select your payment option and complete payment to place your order.



Cohort Classroom Locations

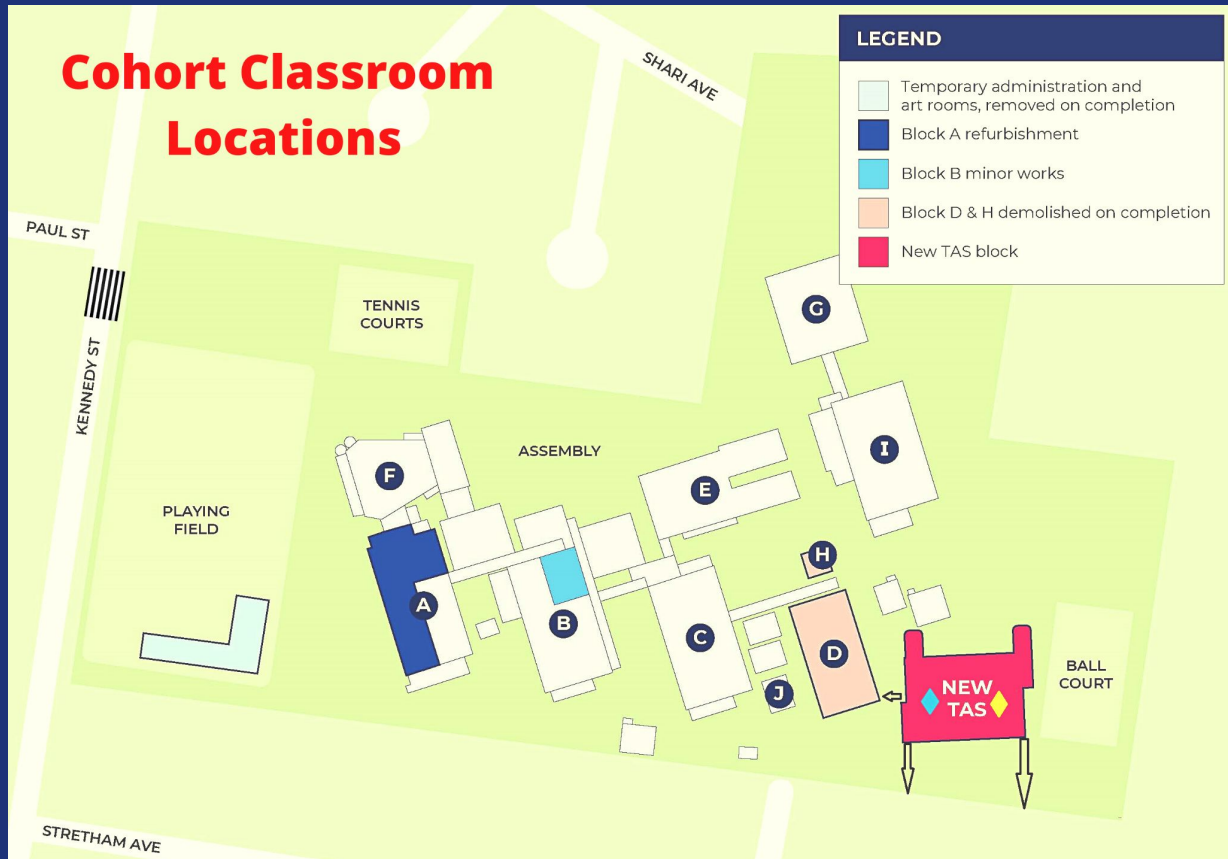

Classroom Locations

Year	Cohort Location
7	A Block First Floor
8	B Block A2 Demountable
9	E Block P2, P5
10	C Block Ground Floor
11	C Block First Floor Library

Year 7 Classrooms - A Block First Floor

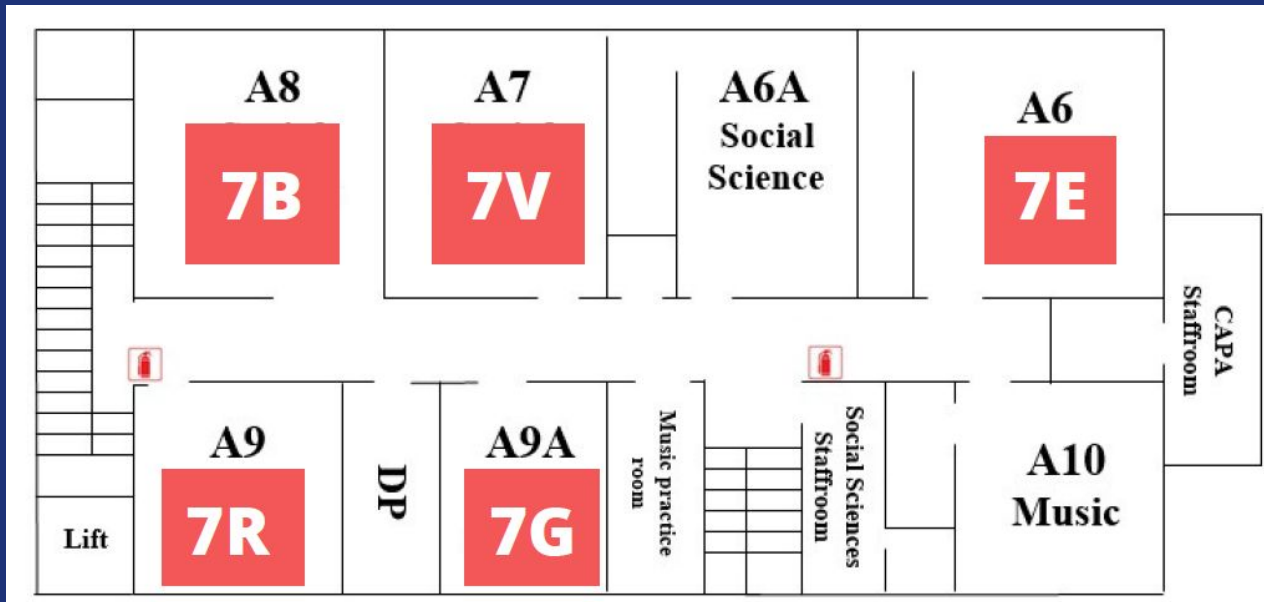

7E - Room A6

7V - Room A7

7B - Room A8

7R - Room A9

7G - Room A9A

Tech - Outdoor Learning TBC
Meet Teacher on the
Front Oval

Front Oval

Year 7 Playground: Before school, Recess, Lunch
Meet Teachers at the start of Period 1,3,5

Admin Demountable Student Office

Year 7 Toilets

Year 8 Classrooms - B Block, A2 Demountable

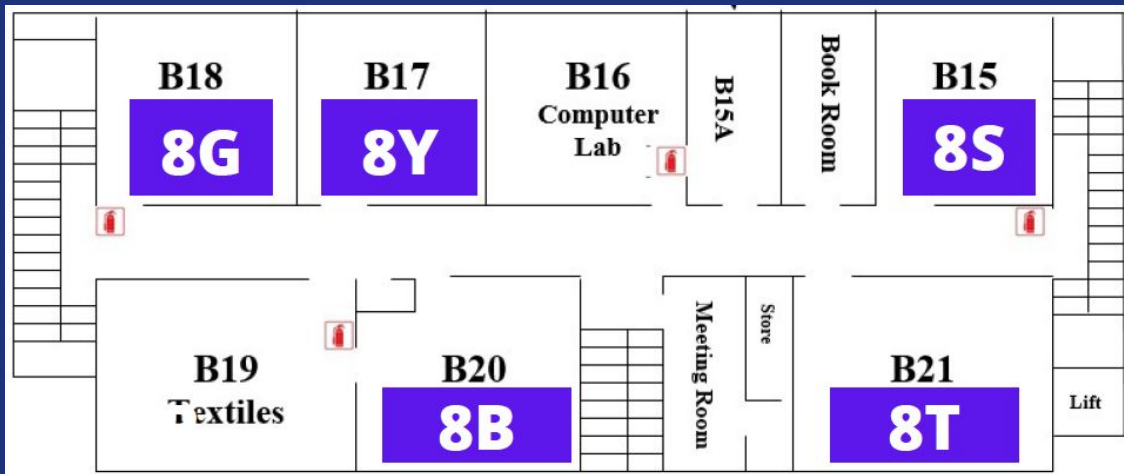
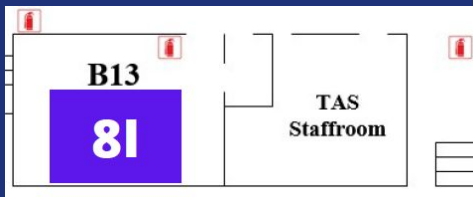

8S - Room B15

8T - Room B21

8Y - Room B17

8G - Room B18

8B - Room B20

8I - Room B13

8O - Room A2

Tech - Outdoor Learning TBC

BasketBall Court & Gazebo Area

Year 8 Playground: Before school, Recess, Lunch
Meet Teachers at the start of Period 1,3,5

Toilet Entry Ramp

Year 8 Toilets



Year 9 Classrooms - E Block Science, P2, P5

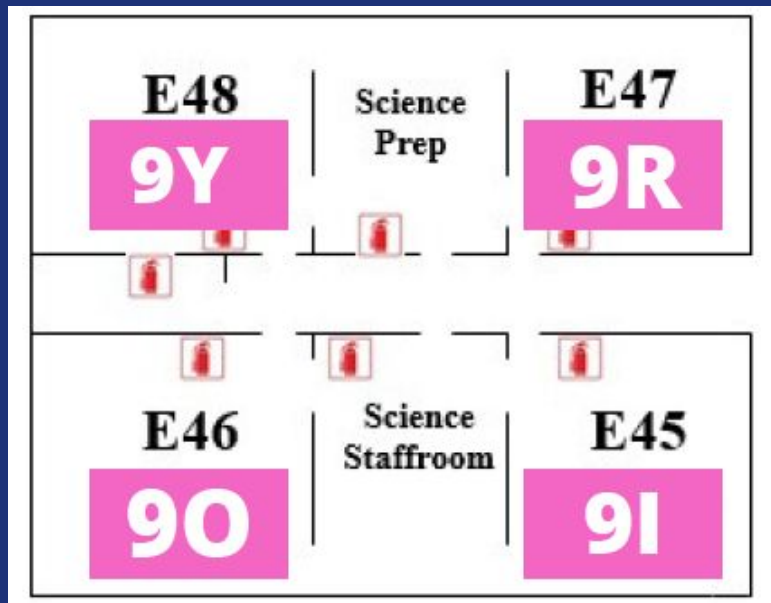

9B - Room P2

9G - Room P5

9I - Room E45

9O - Room E46

9R - Room E47

9Y - Room E48

Electives - Outdoor Learning TB

Aboriginal Garden & Futsal Court

Year 9 Playground: Before school, Recess, Lunch
Meet Teachers at the start of Period 1,3,5

Toilet Top Corridor

Year 9 Toilets



Year 10 Classrooms - C Block Ground Floor

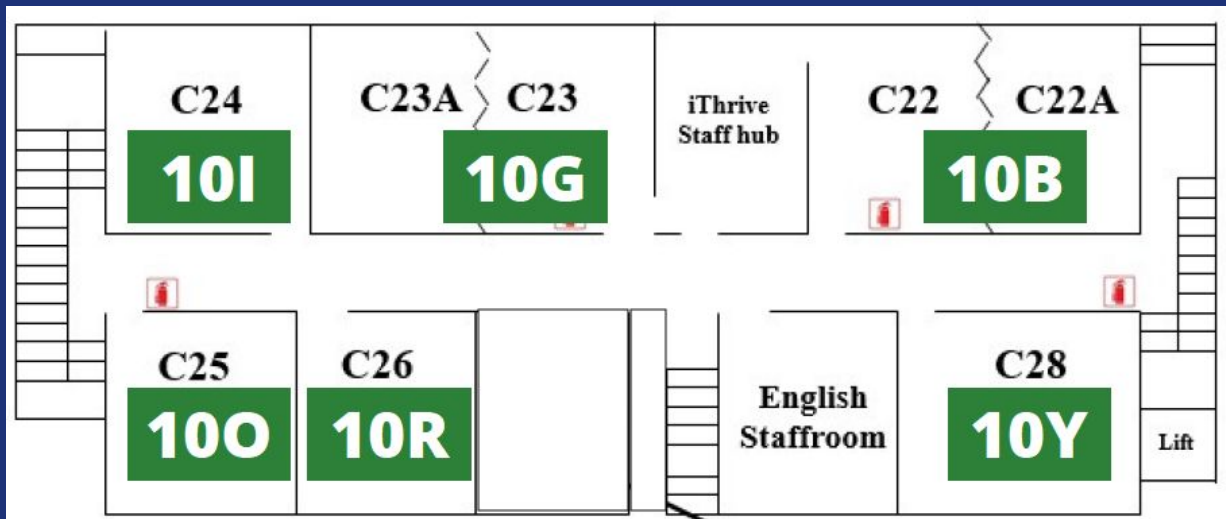

10B - Room C22

10G - Room C23

10I - Room C24

10O - Room C25

10R - Room C26

10Y - Room C28

Electives - Outdoor Learning TBC

Lower Quad

Year 10 Playground: Before school, Recess, Lunch
Meet Teachers at the start of Period 1,3,5

Canteen Entry Gate

Year 10 Toilets



Year 11 Classrooms - C Block 1st Floor, Library

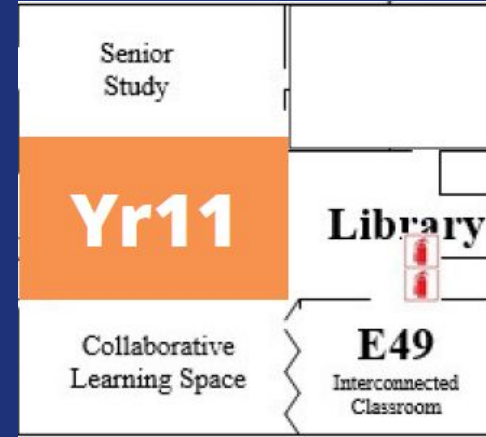
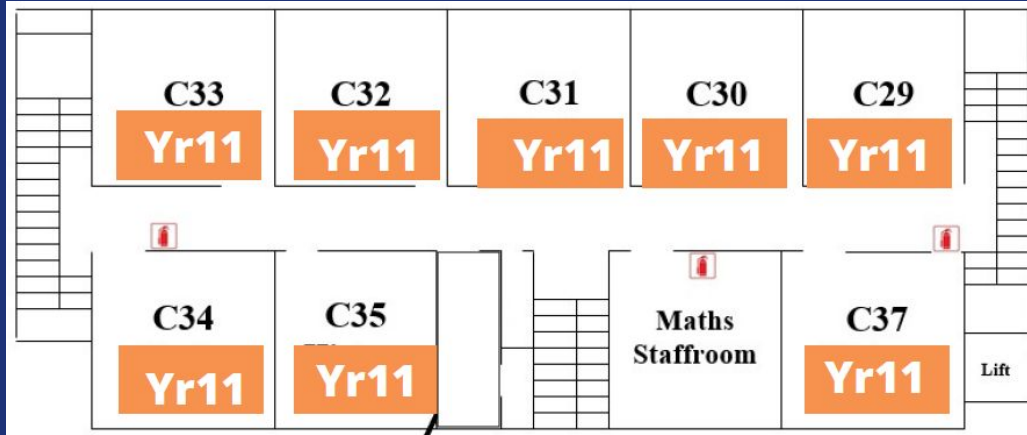

C29

C30

C31

C32

C33

C34

C35

C37

E49

Library

Top Quad, Cafe Area

Year 11 Playground: Before school, Recess, Lunch

Canteen Exit Gate

Year 11 Toilets



Special Education Classrooms - A Block Ground Floor

Front Oval

Year 7 Playground: Before school, Recess, Lunch
Meet Teachers at the start of Period 1,3,5

Admin Demountable Student Office

Special Education Toilets

Exit from School

2.55pm - Kennedy Street Driveway

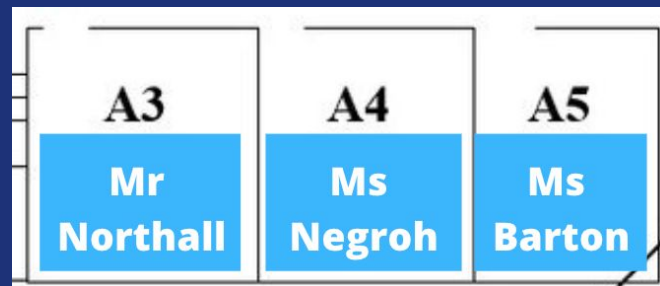

School Uniform Rules

Sport Uniform

Students are to wear their Sport Uniform to school on:

- Tuesday - Years 7-10
- Practical lesson for PDHPE, PASS, SLR
- White leather shoes

Change rooms will remain closed until further notice.



Full School Uniform

- Monday
- Wednesday
- Thursday
- Friday

Years 7-10 students are to wear Full School Uniform everyday except Tuesday unless there is a scheduled Practical lesson.



Technology

BYOD

Teachers will continue to post classwork into Google Classroom in Term 4.

All students are encouraged to bring their own device to school with a general notebook and display folder.

Reasons to bring your own device

- Laptop, notebook and plastic sleeve display folder only required
- No requirement to bring change of sport clothes
- Course work can be completed electronically
- Eliminate the need to bring all or most course books to school
- Use of electronic textbooks
- Not reliant on use of shared devices

Zoom Lessons

- Students who are unable to return to school will continue to be supported to learn from home in line with current guidelines.
- Teachers will continue to zoom lessons to allow students to attend the class virtually to listen to teacher instruction.
- All coursework will continue to be uploaded to Google Classroom.



Mask wearing for students and staff

Mask-Wearing Requirements for Students

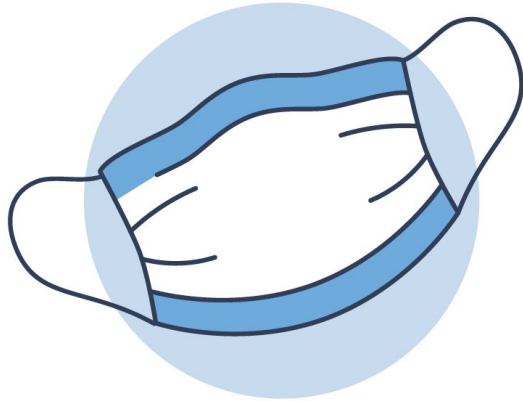

Masks are required indoors for all staff and all students in Year 7 and above.

We encourage you to make sure your child has a mask in their possession each day. In the event that a child loses or misplaces their mask we will have additional supply to accommodate them.

Masks must be worn correctly and are not to be shared.

Masks are mandatory on public transport. All students are required to wear their mask whilst travelling on public transport which includes all school buses.

Ventilation

Having open or well-ventilated spaces reduces the risk of transmission of COVID-19 because infectious particles are more quickly diffused in the open air. The department will continue to work with NSW Health to provide us with advice and guidance on maintaining good ventilation in our school and we will make use of our outdoor spaces wherever practical.

Additionally the school has recently had an extensive ventilation audit and any rooms which are not considered well ventilated will not be in use.

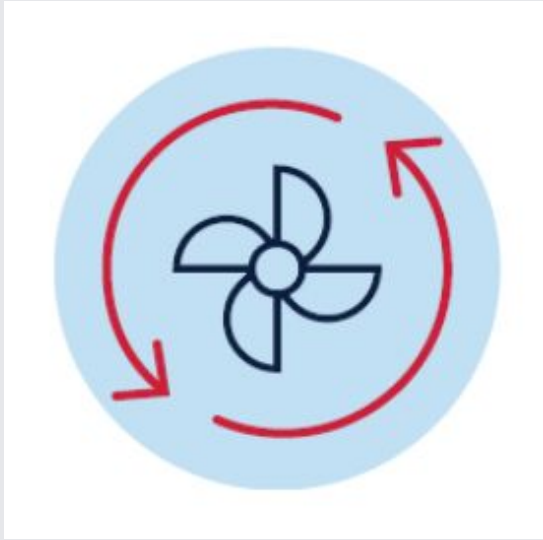

Ventilation - Cooler Classrooms Program

Picnic Point High School now has fully installed and operational Cooler Classrooms equipment, thanks to the NSW government investment of more than \$500 million dollars over five years to improve indoor comfort and air quality in public schools around the state.

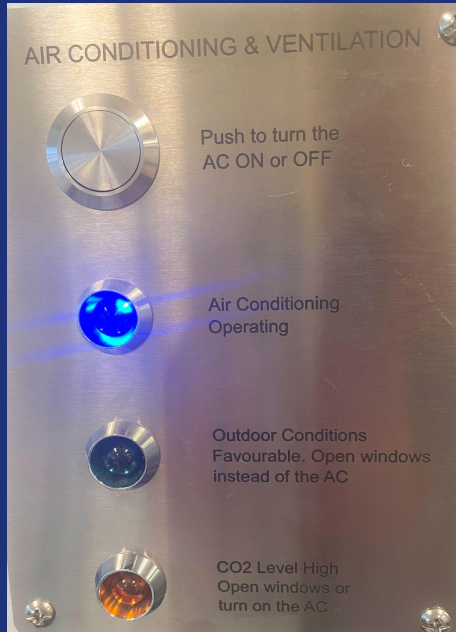

Fresh air ventilation systems maintain healthy air quality with smart outdoor weather monitors linked to interactive control systems located in each classroom.



Reverse-cycle air conditioning will now keep learning spaces comfortable during hot summers and chilly winters while fans and fresh air ventilation systems maintain healthy air quality in 34 classroom spaces.

School Activities

During Term 4 many school-based activities will remain on hold until NSW Health advise otherwise.

This includes large celebrations like assemblies, presentation days and graduations, arts and sports events. If NSW Health advice changes, then we will let you know as soon as possible.

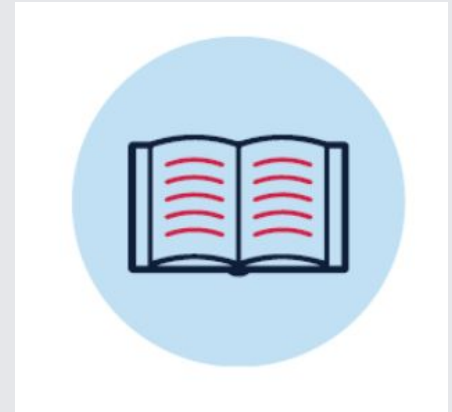

Date	Event
Friday 3 December	Year 12 Sign Out Day
Friday 10 December	Cohort Presentations
Tuesday 14 December	Year 12 Graduation - Livestream

Orientation and transition to school

Onsite orientations and transition programs are not currently allowed in person on school sites until we are advised differently by NSW Health.

We'll share more information in the coming weeks about our school's virtual orientation and transition program.



HSC student revision and support

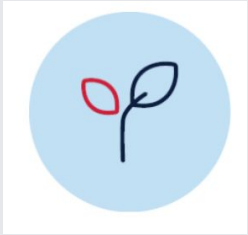

- Teachers of HSC subjects are available for revision and support during their usual timetabled HSC classes.
- Online workshops were held in Week 2.
- Study bubbles have commenced and will continue till Friday 22 October.
- Seminars are being held in Week 3-4 in the School Hall.

What you need to know about HSC exams

We are putting in place and preparing COVID-safe arrangements for exams to minimise mixing between students.

These plans include appropriate spacing for students and that exams are conducted in well-ventilated rooms and spaces, mask wearing for students and staff onsite.

We are also organising alternative venues in the event we need to relocate the exams.



Further information and questions

All of our students are expected to be back at school on Monday 25 October.

Parents and students will be notified if a decision is made to close the school due to a confirmed case of COVID-19. During this time we will continue to provide learning from home activities and we will let you know when we can return to face-to-face learning.

For further information, please visit the department's Advice for Families page or contact the school directly.

<https://education.nsw.gov.au/covid-19/advice-for-families>



Thank you for attending the Picnic Point High School Return to School Virtual Meeting